

ANGLEMASTER 1000/2000/2000DX MACHINES SN 2769 - 11958



Contents

INTRODUCTION	3
SOLEPLATE ASSEMBLIES.....	4
TRAVERSE SYSTEM	8
83 - TRAVERSE MOTOR & GEARBOX - A06038	9
83 - TRAVERSE MOTOR & GEARBOX – A06019	9
ELECTRICAL PANEL (MACHINES WITH AUTO TRAVERSE)	10
ELECTRICAL PANEL (MACHINES WITH MANUAL TRAVERSE).....	11
OPERATOR PANEL (MACHINE WITH MAGNETS)	13
OPERATOR PANEL (MACHINE WITH MANUAL TRAVERSE).....	14
MAIN MOTOR CONTROL PANEL.....	15
MAIN MOTOR DRIVE.....	16
GRINDING CARRIAGE	19
GRINDING CARRIAGE (PARTS)	20
FRAME AND COOLANT	22
64 – COOLANT TANK	Error! Bookmark not defined.
MOUNTING BAR AND ADJUSTING HANDLES	23
MOUNTING BAR AND ADJUSTING HANDLES (PARTS LIST)	24
11 – FEEDSCREWS.....	25
15 - R/H LOCKING LEVER.....	26
GUARD.....	27
CONTACT US.....	28

INTRODUCTION

This manual is intended to cover the last remaining parts available for the Anglemaster range of machines 2769 – 11958.

All Bernhard grinders (both Anglemaster and Express Dual) are fitted with a rating plate that gives the serial number of the machine. When calling to order parts please have the serial number to hand.

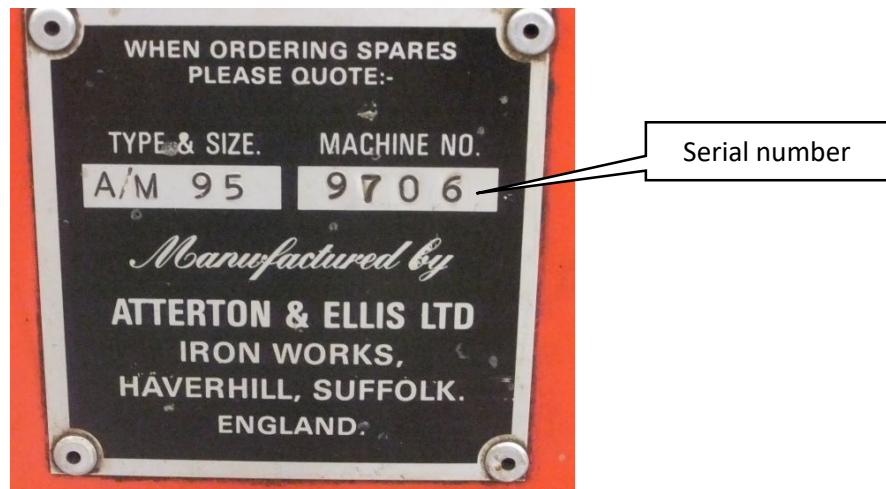

Thank you for purchasing a Bernhard grinder, if you are considering replacing your grinder with a newer model please contact our head office.

Bernhard and Company Ltd

Bilton Road
Rugby
Warwickshire
England
CV22 7DT

Telephone:
1-888 474 6348 (Toll free from USA/Canada)
+44 1788 811600 (Worldwide)

Email: info@bernhard.co.uk

SOLEPLATE ASSEMBLIES

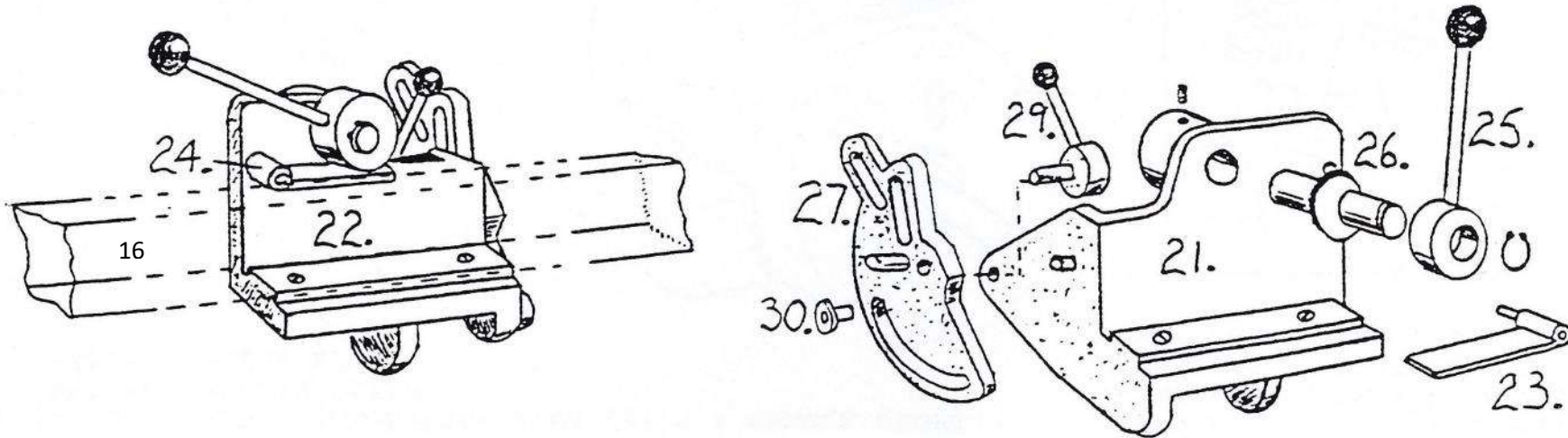

- 16 - Mounting bar - (OBSOLETE)
- 21 - Soleplate bracket RH - (OBSOLETE)
- 22 - Soleplate bracket RH - (OBSOLETE)
- 23 - Steel slip for eccentric R/H - (OBSOLETE)
- 24 - Steel slip for eccentric L/H - (OBSOLETE)
- 25 - Eccentric will ball lever - (OBSOLETE)
- 27 - Slotted quadrant – A04090
- 29 – Quadrant locking lever – A06119
- 30 - Quadrant captive nut – A09023

A09579 - 01 DEC 2015

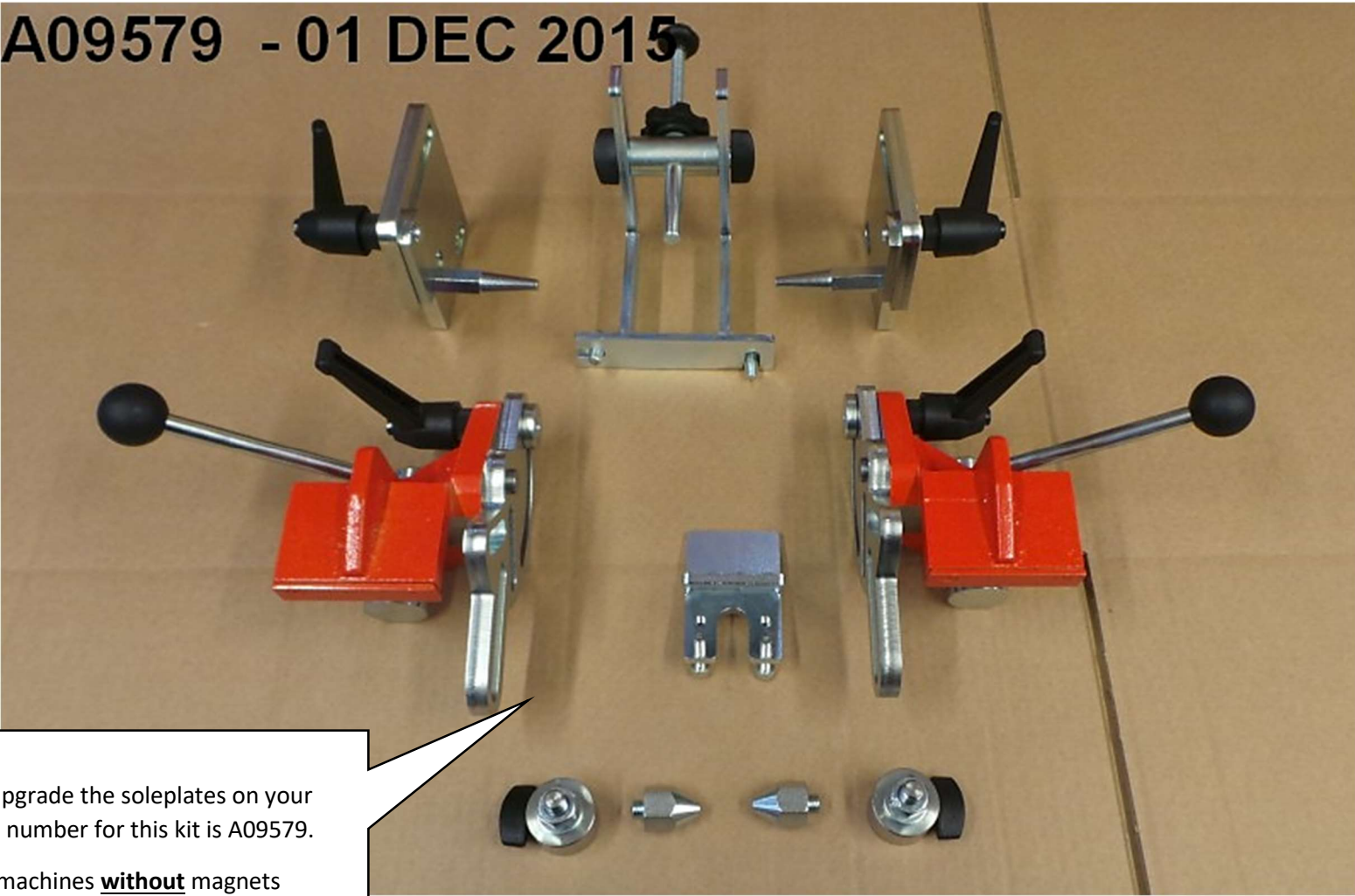

We can offer a kit to upgrade the soleplates on your Anglemaster. The part number for this kit is A09579.

This is suitable for machines without magnets

A09550 - 01 DEC 2015

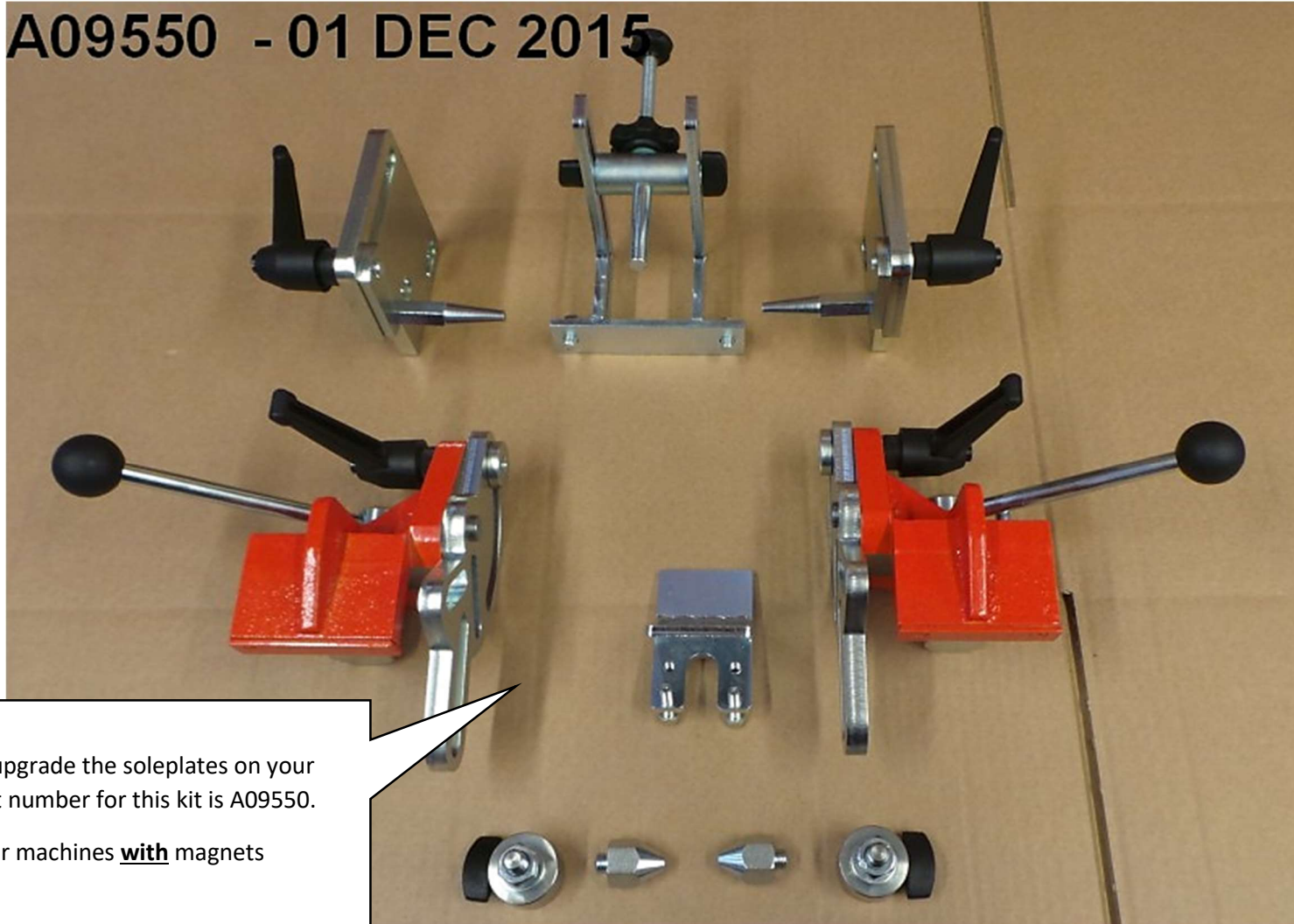

We can offer a kit to upgrade the soleplates on your Anglemaster. The part number for this kit is A09550.

This is suitable for machines with magnets

THIS IS HOW THE SOLEPLATES LOOK FITTED TO AN ANGLEMASTER



TRAVERSE SYSTEM

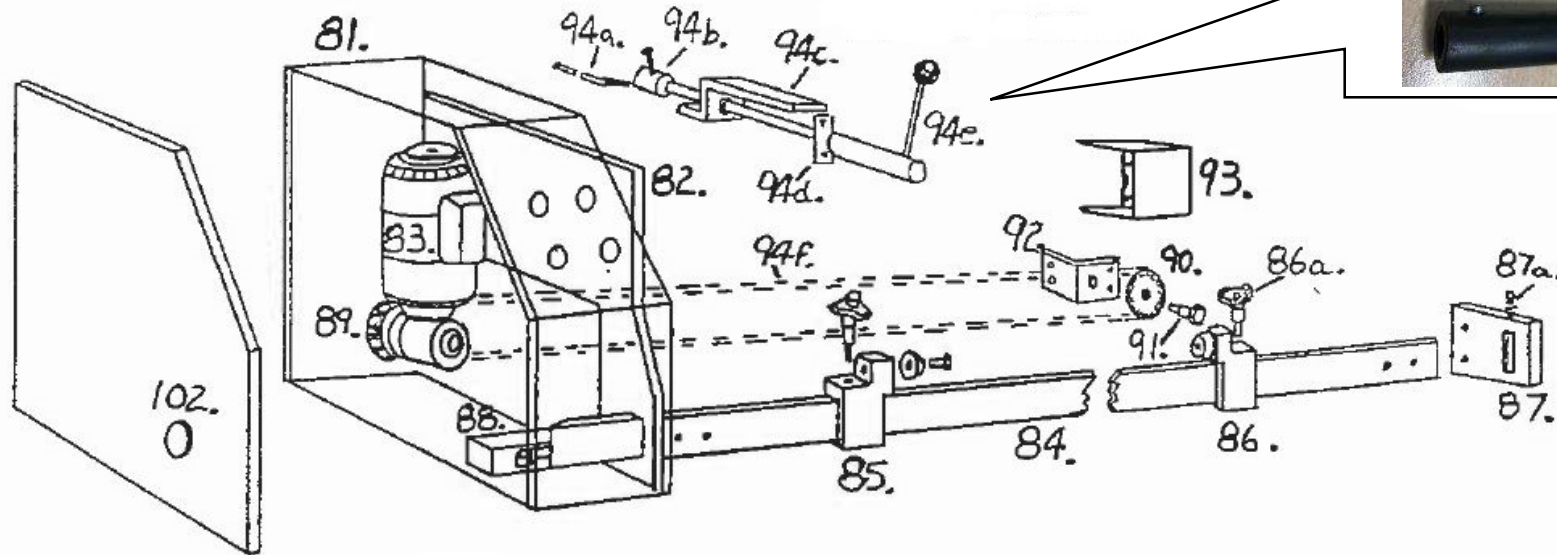

81 – Control box (complete with lid) - (OBSOLETE)	88 – Microswitch – A08111	94D – Plate C/W fixings – (OBSOLETE)
82 – Motor plate - (OBSOLETE)	89 – Drive sprocket – A07604	94E – Lever ONLY – A06158
83 – Traverse motor & Gearbox – (See next page)	90 – Idler sprocket C/W Bush – A07609 + A07704	94F – Traverse chain – A07405
84 – Reversing bar C/W Stop Pins - (OBSOLETE)	91 – Idler sprocket pin – A09058	102 – Overload reset button – (OBSOLETE)
85 – Reversing stop LH & rubber – (OBSOLETE)	92 – Idler sprocket bracket – (OBSOLETE)	
86 – Reversing stop RH & rubber – (OBSOLETE)	93 – idler sprocket guard – (OBSOLETE)	
86A – Thumbscrew for reversing stops – (OBSOLETE)	94A – Clutch slipper plate – A04129	
87 – Reversing bar bracket – (OBSOLETE)	94B – Eccentric (A09159)	
87A – Damping screw and pad – (OBSOLETE)	94C – Bracket – (OBSOLETE)	

83 - TRAVERSE MOTOR & GEARBOX - A06038 REGIONS UK AND EUROPE



83 - TRAVERSE MOTOR & GEARBOX – A06019 REGIONS USA AND CANADA



ELECTRICAL PANEL (MACHINES WITH AUTO TRAVERSE)

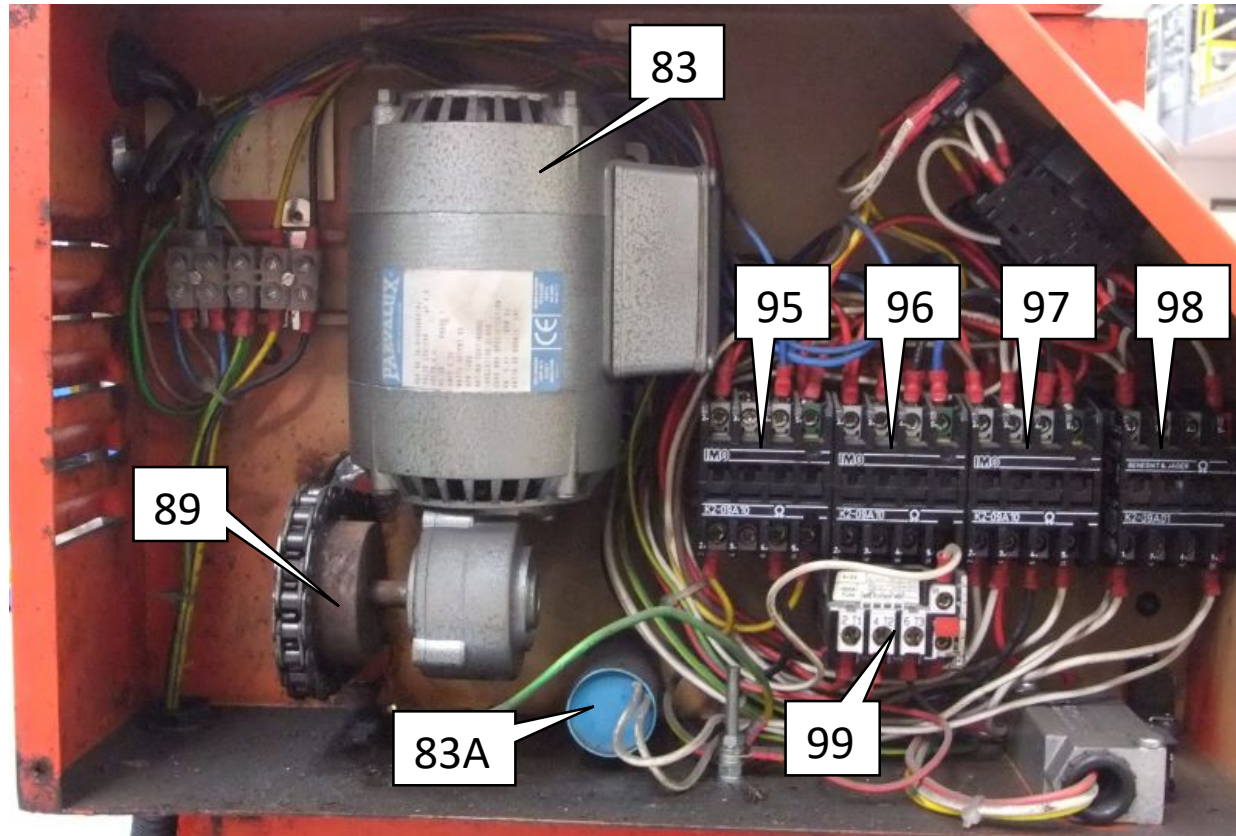

83 – Traverse motor & Gearbox (see above page)	97 – Traverse contactor – A08063
83A – Traverse capacitor – A08029	98 – Traverse reverse contactor – A08062
95 – Coolant contactor – A08063	99 – Thermal overload – A08116
96 – Grinding wheel contactor – A08063	

ELECTRICAL PANEL (MACHINES WITH MANUAL TRAVERSE)

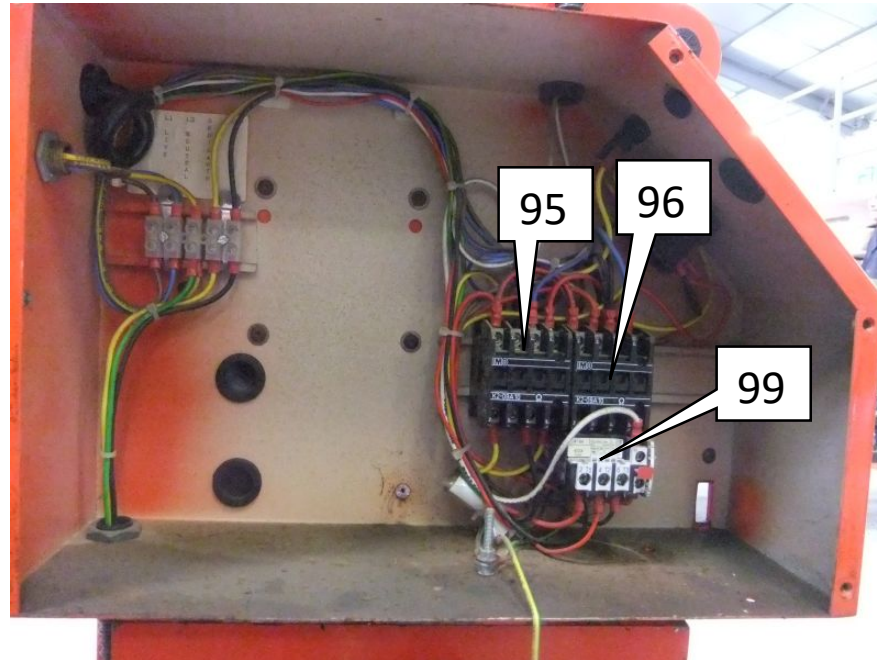

95 – Coolant contactor – A08063
96 – Grinding wheel contactor – A08063
99 – Thermal overload – A08116

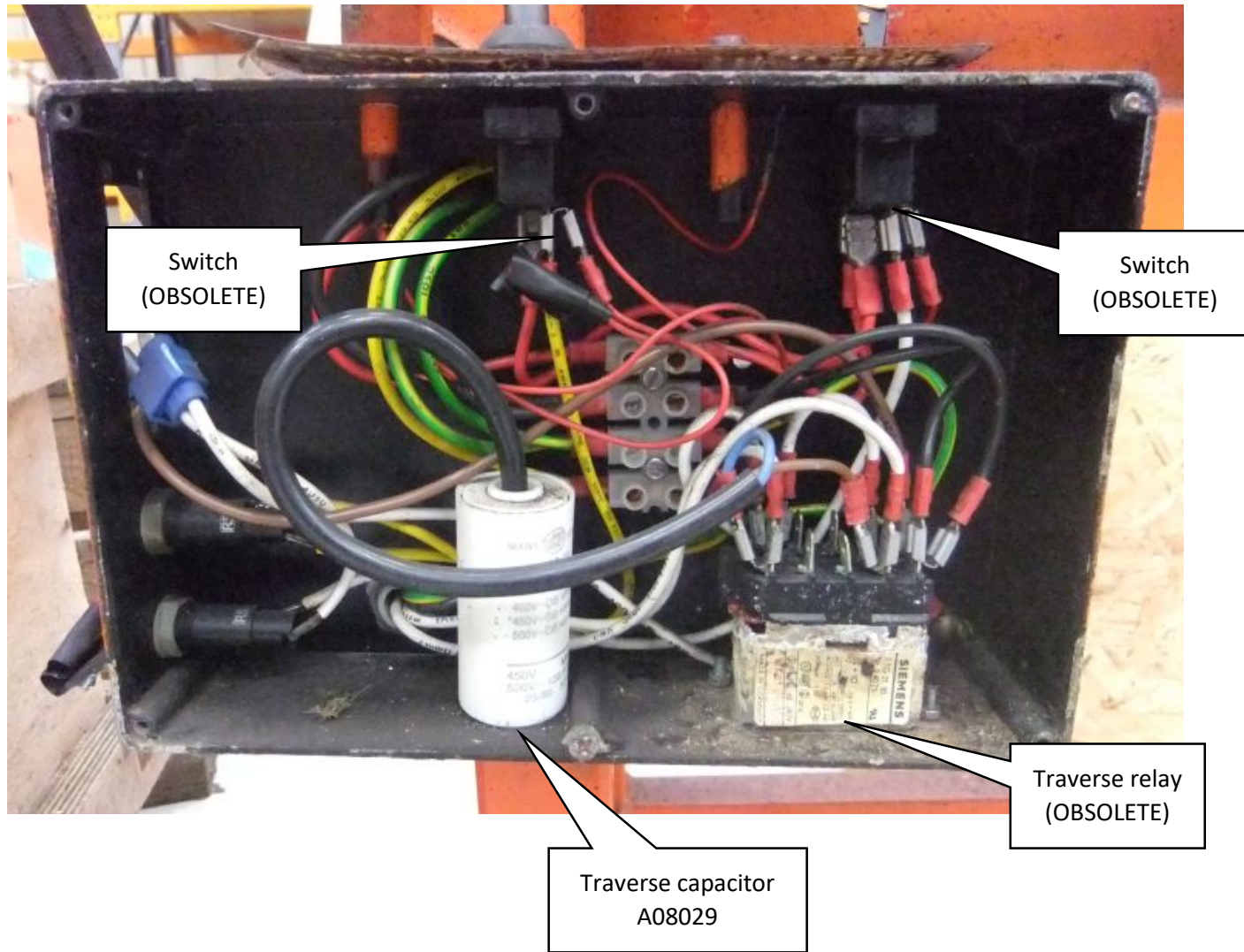

OPERATOR PANEL (MACHINE WITH MAGNETS)



100 – Button – A07092
101 – Fuseholder – A08173
101A – Fuse (2) – A08082
104 – Fuseholder – A08173
104A – Fuse – PLEASE CALL
103 – Switch – (OBSOLETE)

OPERATOR PANEL (MACHINE WITH MANUAL TRAVERSE)

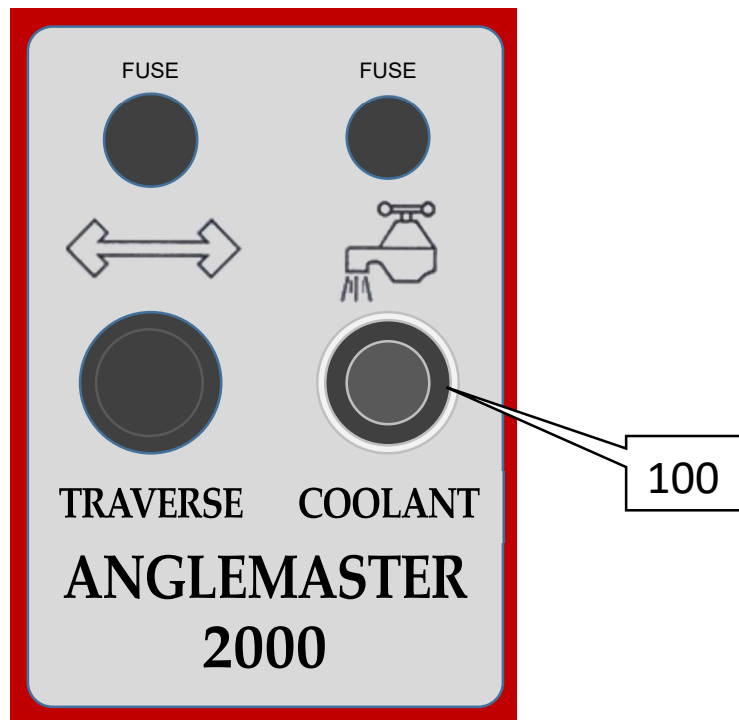

100 – Button – A07092

MAIN MOTOR CONTROL PANEL

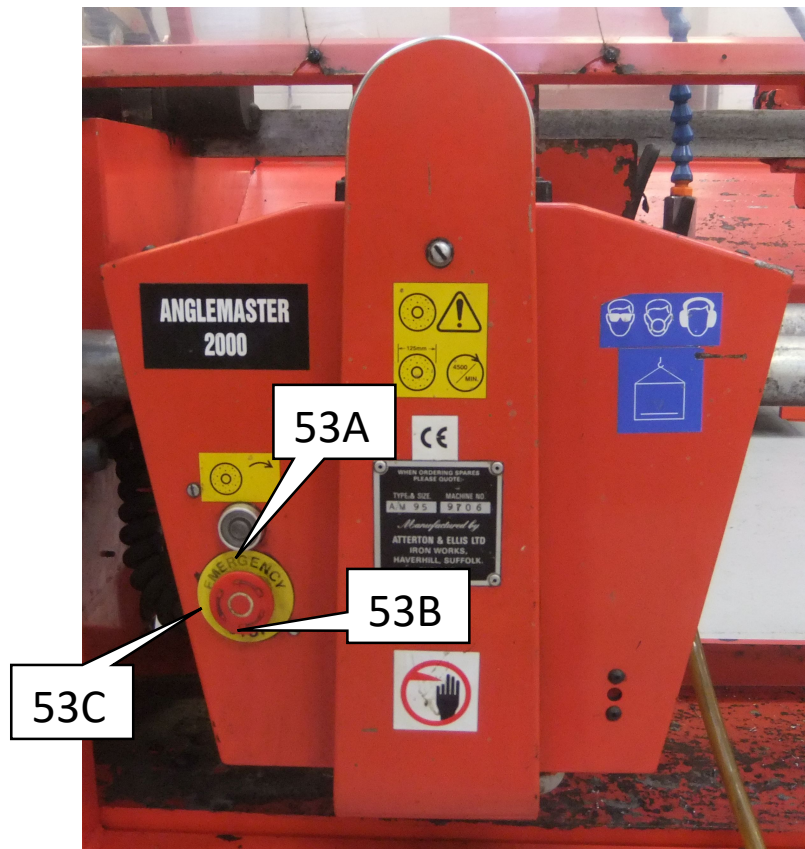

53A – Illuminated start button – (OBSOLETE)

53B – Stop button – (OBSOLETE)

53C – Yellow disc for stop button - (OBSOLETE)
--

MAIN MOTOR DRIVE

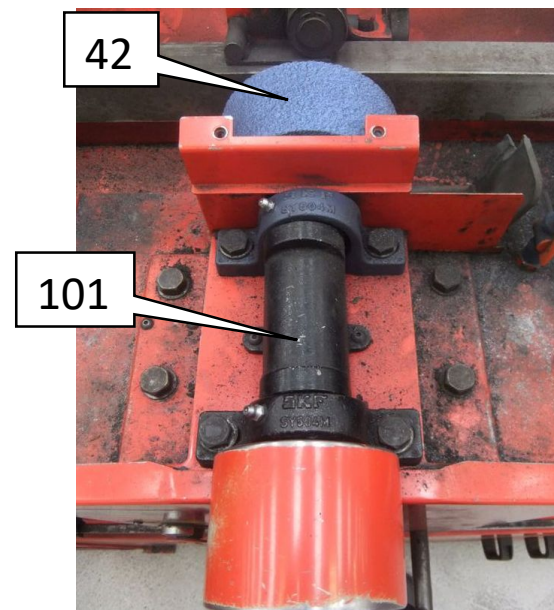
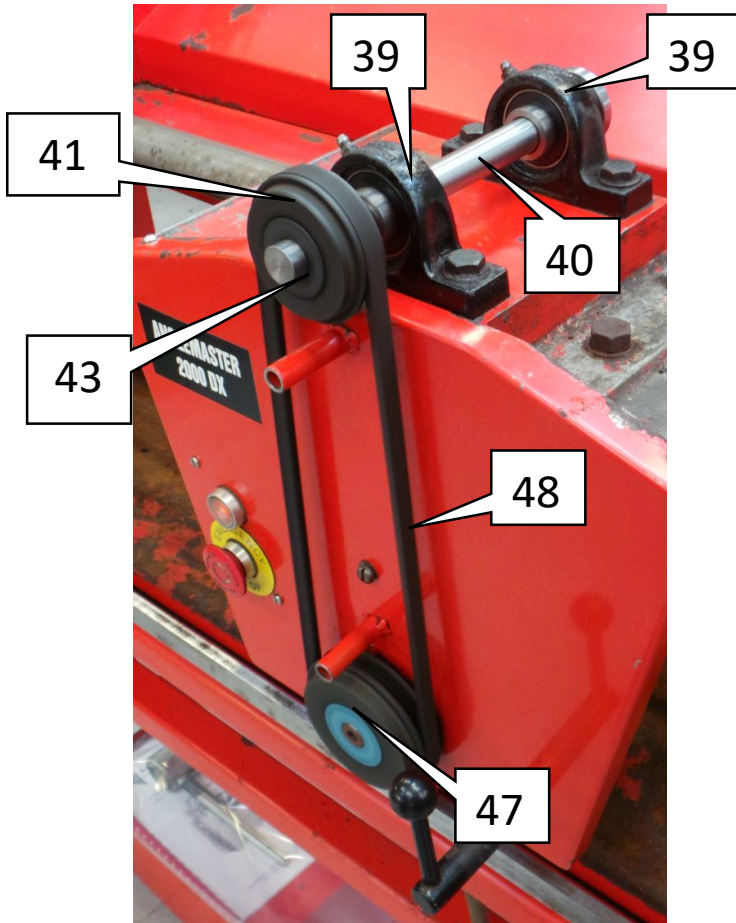

39 – Grinding wheel Plummer block (2) – A07712
40 – Grinding wheel shaft C/W, nut, and pulley – A09056
41 – Pulley -- A07202
42 – Grinding Stone - SEE PAGES BELOW
43 – Taper Lock bush -- A07301
47 – Motor pulley C/W taper bush – A07207
48 – Vee belt – A07104
101 – Grindstone shaft guard – A04281

42 – GRINDING STONE – A06509



42 – GRINDING STONE – A06986

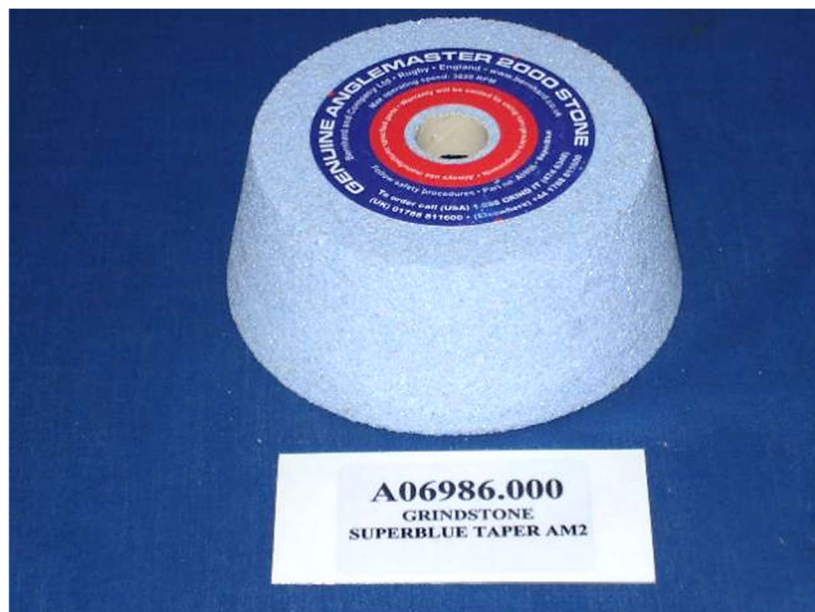

42 – GRINDING STONE – A06506



GRINDING CARRIAGE

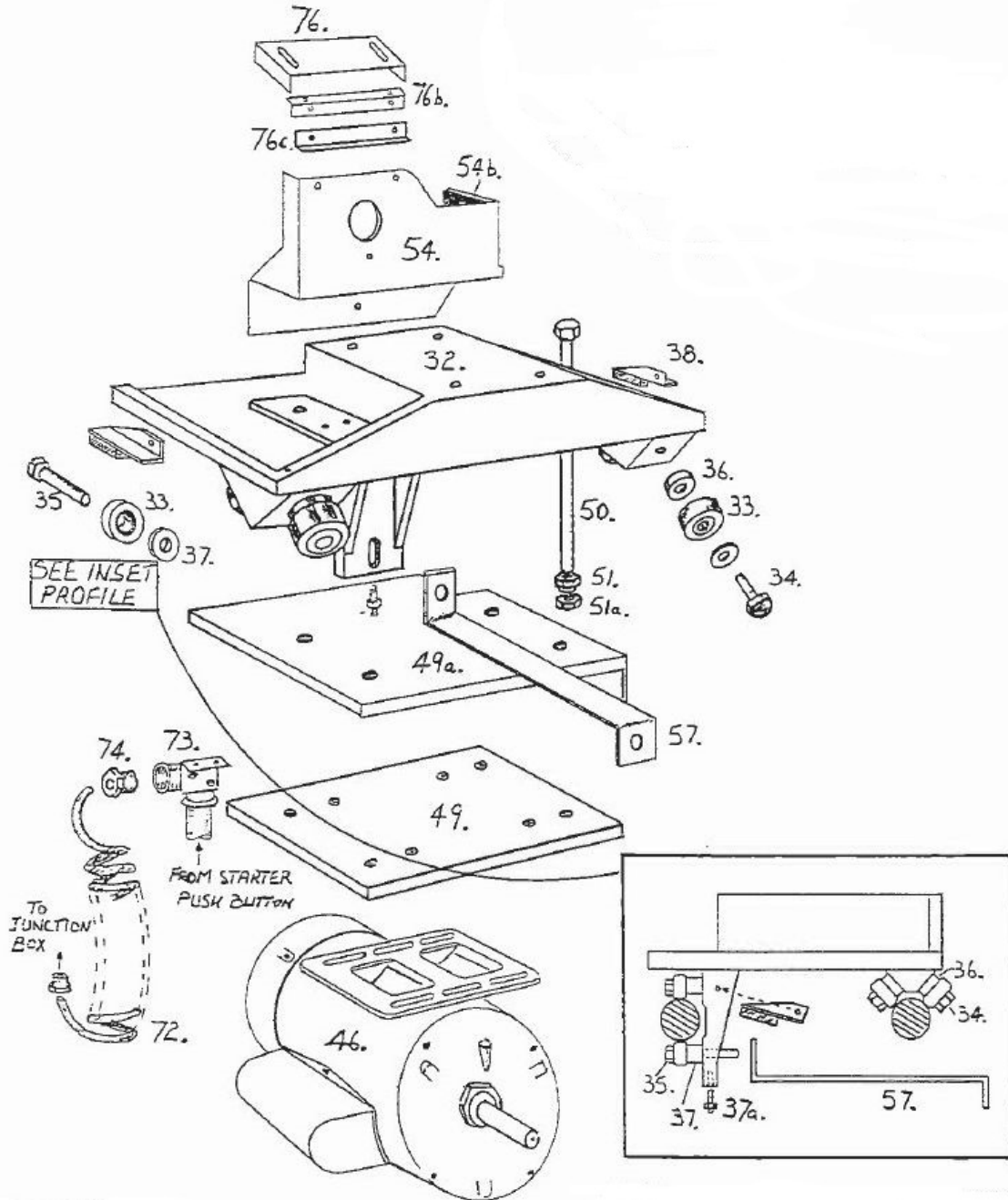

GRINDING CARRIAGE (PARTS)

33 – Needle roller (6) – A07713	50 – Motor suspension rods – (OBSOLETE)
34 – Needle roller screws (short) (4) – (OBSOLETE)	51 – Nylon nuts for rods – (OBSOLETE)
35 - Needle roller screws (Long) (2) – (OBSOLETE)	54 – Grinding wheel guard plate – (OBSOLETE)
36 – Needle roller spacer (Short) (4) – (OBSOLETE)	54B – Rubber splash deflector – (OBSOLETE)
37 – Needle roller spacer (Long) (2) – (A09187)	72 – Extendible flexible cable – A08805
37A – Rear roller adj screw – (OBSOLETE)	73 – Inspection elbow C/W mounting – (OBSOLETE)
38 – Rail wiper assy (2) – (OBSOLETE)	74 – Brass gland sockets (2) – (OBSOLETE)
46 – Main grinding motor – (OBSOLETE)	76 – Grinding wheel top guard – (OBSOLETE)
49 – Motor plate – (OBSOLETE)	76B – Mounting bracket for top guard – (OBSOLETE)
49A – Splash guard - (OBSOLETE)	76C – Small shaft guard - (OBSOLETE)

46 – MAIN GRINDING MOTOR
REGIONS UK AND EUROPE – A06001
(OBSOLETE)

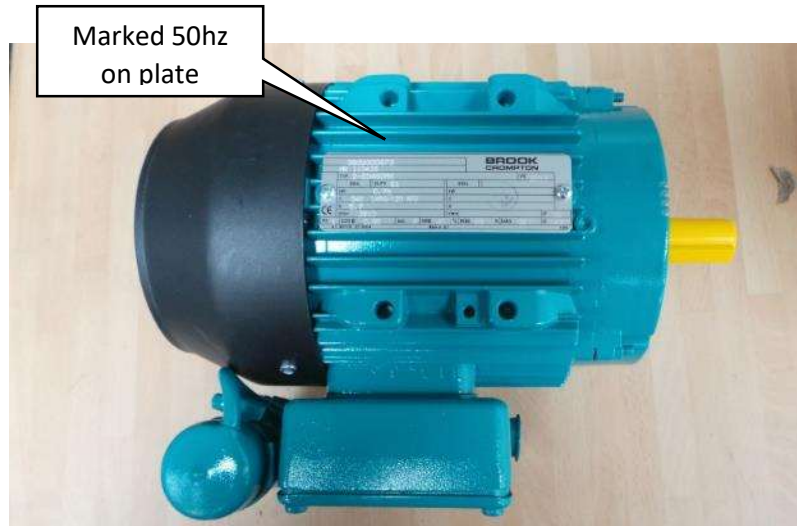

46 – MAIN GRINDING MOTOR
REGIONS USA AND CANADA – A06002
(OBSOLETE)



FRAME AND COOLANT

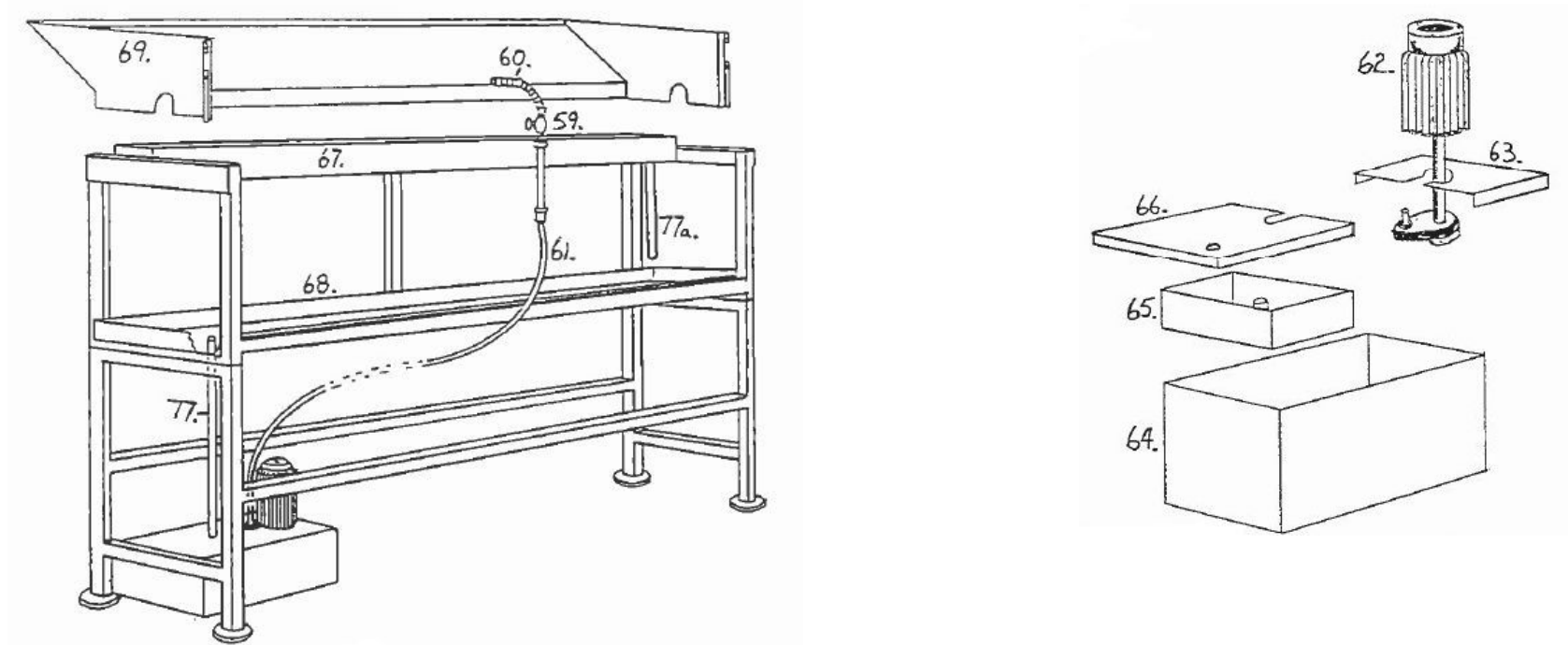

59 – Coolant tap (ONLY AVAILABLE AS PART OF ITEM 60)	66 – Coolant tank cover - (OBSOLETE)
60 – Adjustable coolant nozzle – A06773	67 – Coolant trough - (OBSOLETE)
61 – Flexible coolant pipe – A06733	68 – Coolant tray - (OBSOLETE)
62 – Coolant pump and motor – (OBSOLETE)	69 – Splash guard - (OBSOLETE)
63 – Coolant motor mounting plate - (OBSOLETE)	77 – Coolant return pipe 16 ¼" - (OBSOLETE)
64 – Coolant tank – (OBSOLETE)	77A – Coolant return pipe 10 ½" - (OBSOLETE)
65 – Coolant settlement tray - (OBSOLETE)	

MOUNTING BAR AND ADJUSTING HANDLES

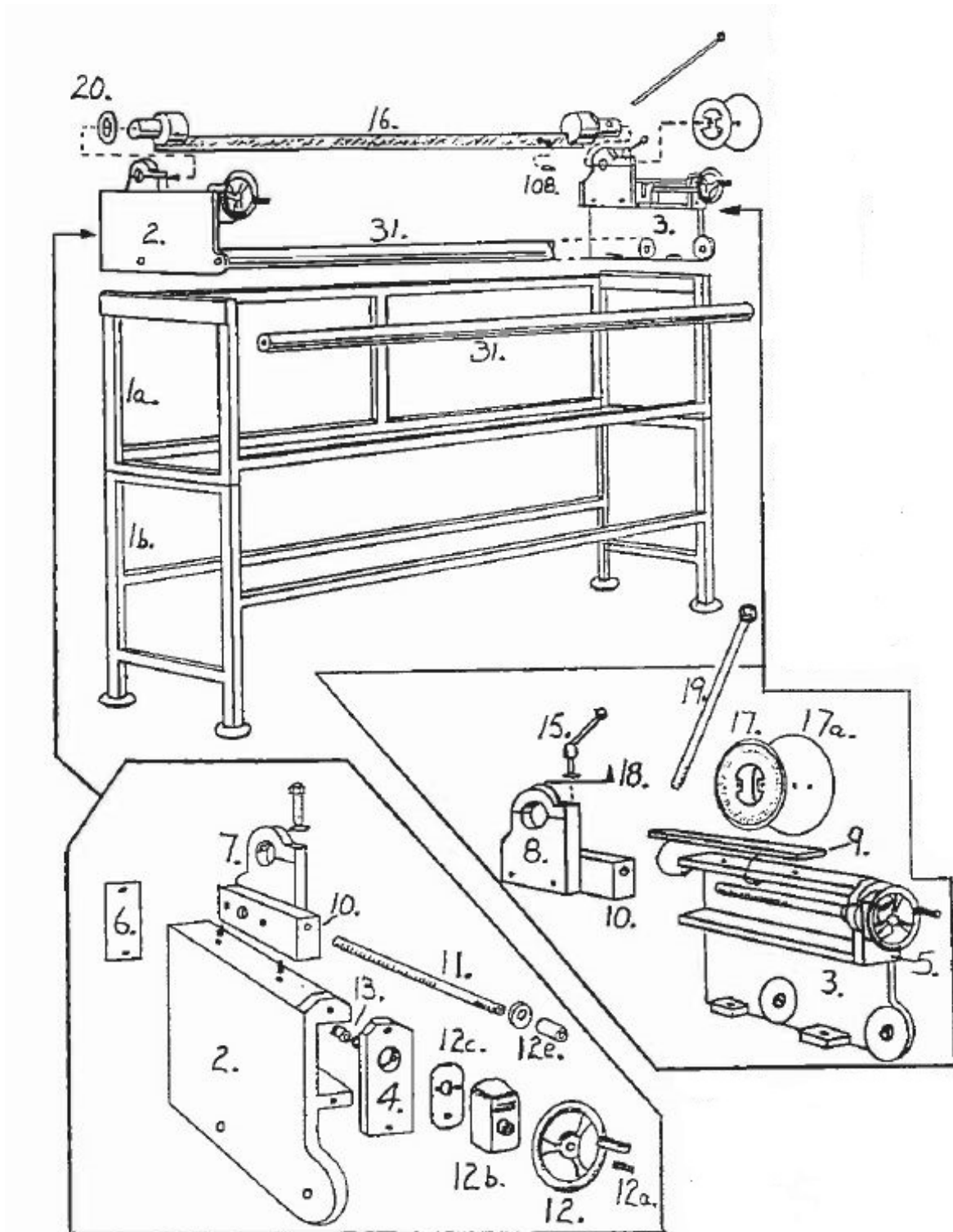



MOUNTING BAR AND ADJUSTING HANDLES (PARTS LIST)

1A – Frame Assy (Top) - (OBSOLETE)	12A – Grubscrews for handwheels – A05110
1B – Frame Assy (Bottom) - (OBSOLETE)	12B – Counters (2) – (OBSOLETE)
2 – Feed slide casting LH - (OBSOLETE)	12C – Mounting plate (2) - (OBSOLETE)
3 – Feed slide casting RH - (OBSOLETE)	12E – Spacers (2) - (OBSOLETE)
4 – Slide cap with Boss LH - (OBSOLETE)	13 – spacers and spring washers (OBSOLETE)
5 – Slide cap with Boss RH - (OBSOLETE)	15 – R/H locking lever (See next page)
6 – Rear slide caps (plain) (2) - (OBSOLETE)	16 – Mounting bar - (OBSOLETE)
7 – Mounting bar clamps C/W Bolthole L/H - (OBSOLETE)	17 – Protractor scale – A06617
8 – Mounting bar clamps R/H - (OBSOLETE)	17A – Backing plate - (OBSOLETE)
9 – 1" x 1/8" adjustable slip - A04004	18 – Pointer - (OBSOLETE)
10 – Slide blocks (2) - (OBSOLETE)	19 – Mounting bar control lever – A09280
11 – Feedscrews (2) – see below	20 – Mounting bar spacer collar (2) - (OBSOLETE)
12 – Handwheels (2) – A06114	31 – precision ground rails (2) – A06757

11 – FEEDSCREWS

Over the years a number of different length feed screws have been used. To supply you the correct feed screw we need the following information.

Length of threaded part “A”

Length of plain part “B”

Length of threaded part “C”

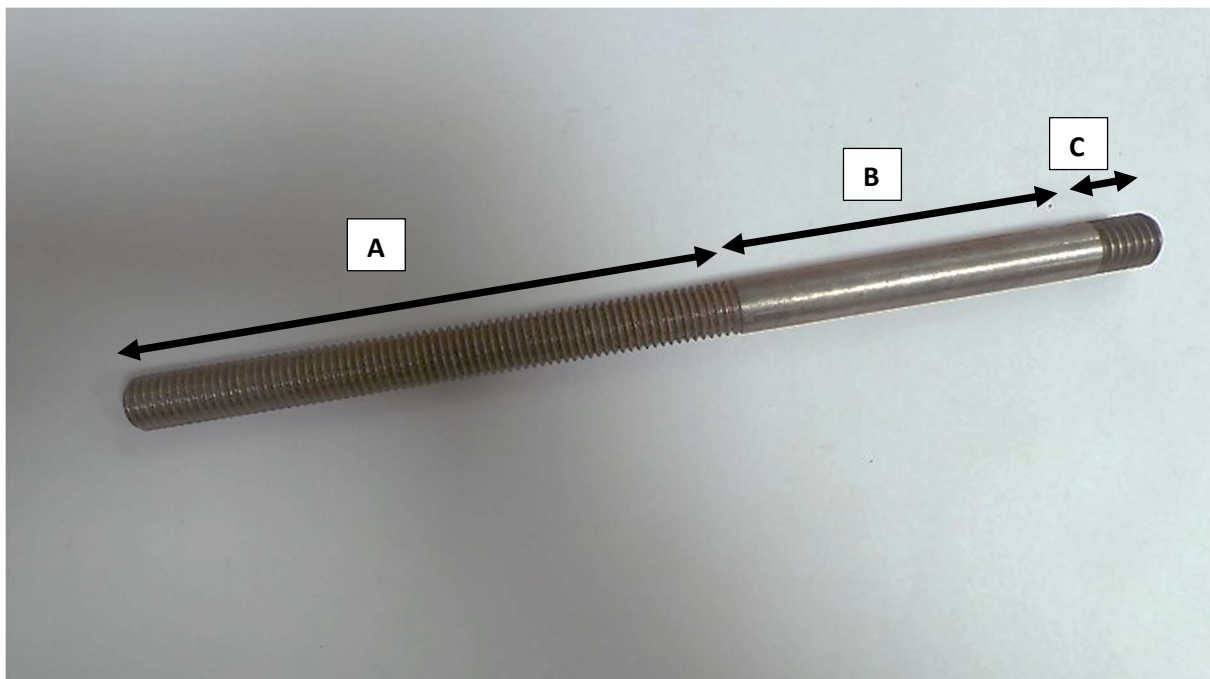

15 - R/H LOCKING LEVER



Mounting bar locking lever



Machines up to **9889** had $\frac{1}{2}$ "
Witworth thread. Use part number
A06159 to order replacements



Machines **9890** onward had a metric
M12 thread. Use part number **A06123**
to order replacements

GUARD

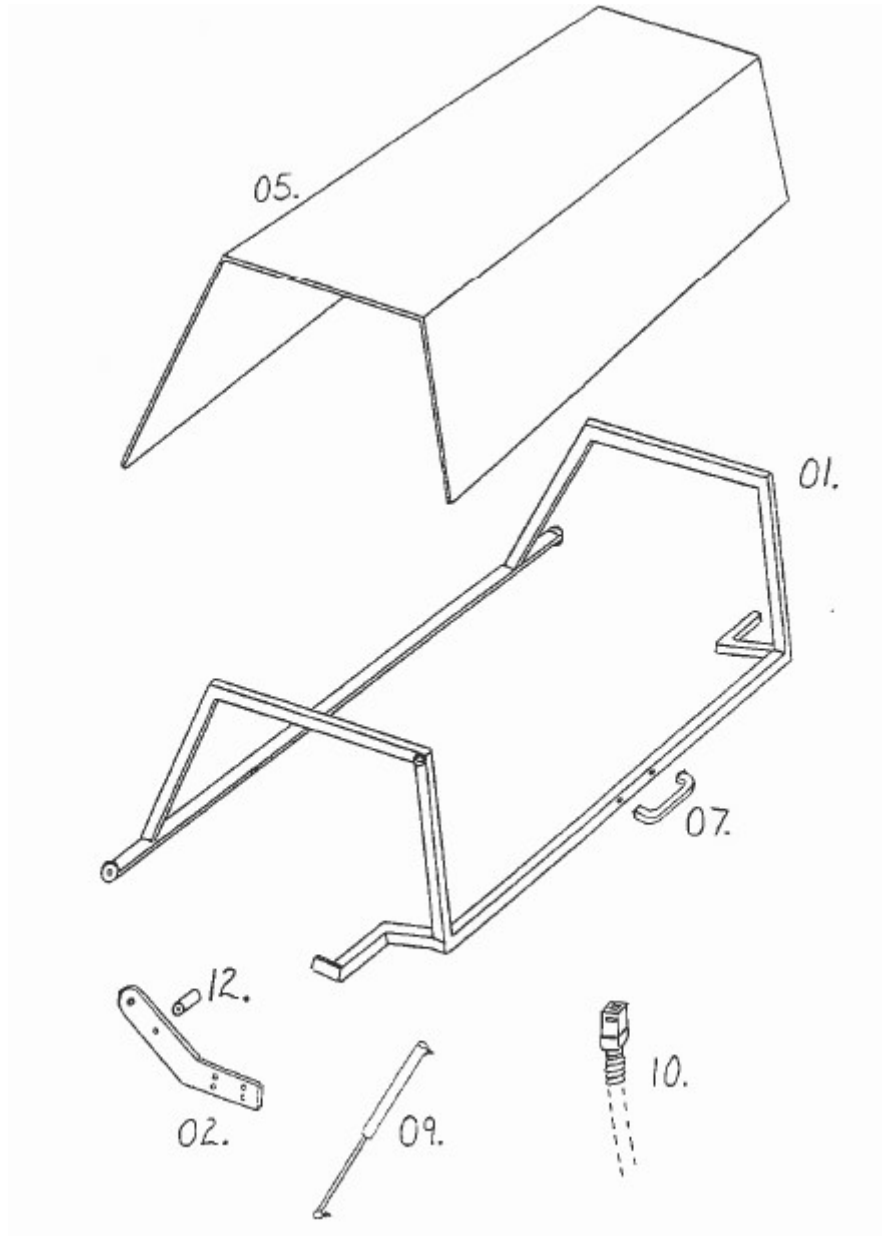

01 – Guard main frame – (OBSOLETE)	09 – Gas Strut – A06825
02 – Mounting brackets (2) – (OBSOLETE)	10 – Safety switch – A08137
05 – Polycarbonate cover – (OBSOLETE)	12 – Spacer – (OBSOLETE)
07 – Lifting handle – (OBSOLETE)	

TOOLS AND ACCESSORIES

A09119 – TAPER PIN

A09119 - 21 MARCH 2014



A09266 – TAPER PIN

A09266 - 21 MARCH 2014





BERNHARD

CONTACT US

Global Parts Service

Telephone:

1-800 392 2235 (Toll free from USA/Canada)

+44 1440 702312 (Worldwide)

Email: parts@bernhard.co.uk

Unit 11

Homefield Road

Haverhill

CB9 8QP

England